

**FSCD - IJCAR PARIS 2020**

UNIVERSITÉ PARIS 13, SORBONNE PARIS CITÉ



# Paris 2020 FSCD *ijcar*

- \* **FSCD main conference (4 days)**

**Mon 29 - Tue 2 July**



- \* **Workshops (1+2 days)**

- \* **Pre workshops: Sun 28 June**



- \* **Post workshops: Fry 3 - Sat 4 July**

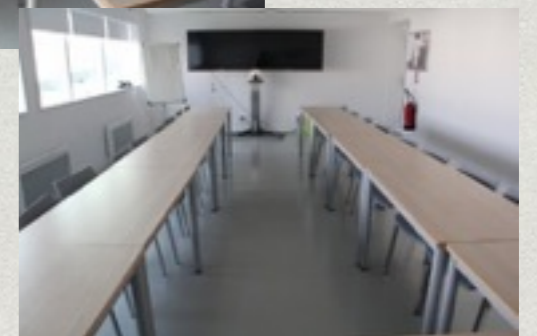





UNIVERSITÉ **PARIS 13**

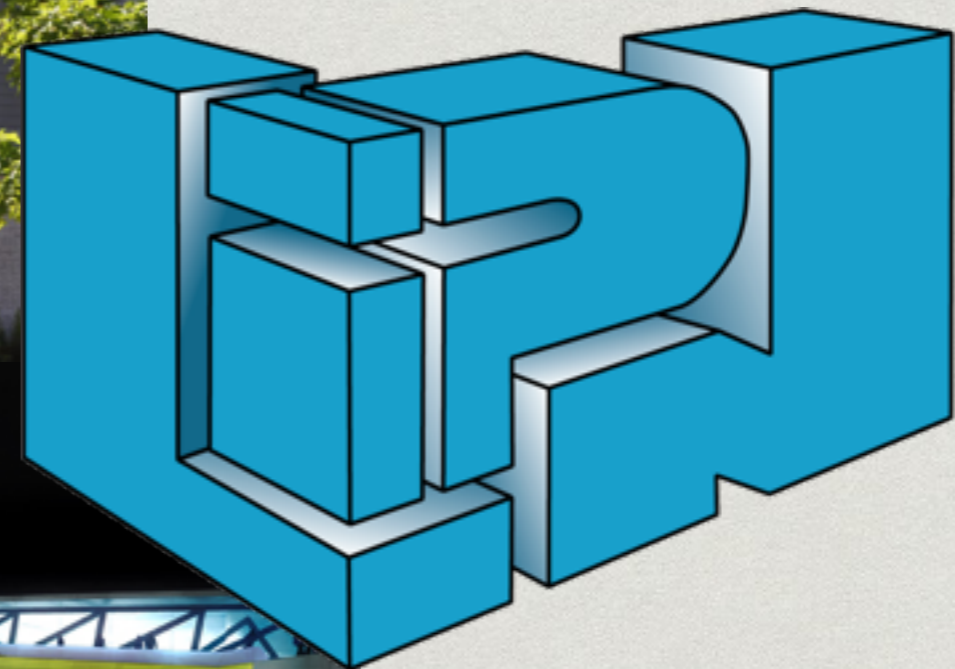

## **Université Paris 13, Sorbonne Paris Cité**

Organisation: **LIPN, Institut Galilée**

Venue: **Maison des Science de l'Homme (MSH) Paris Nord**



# Local organisation

- \* Local organisers

- \* **Stefano Guerrini (LIPN P13)**, *FCSD Conference Chair*
- \* **Giulio Manzonetto (LIPN P13)**, *Workshops Chair*
- \* **Kaustuv Chaudhuri (INRIA Parsifal - LIX)**, *IJCAR Conference Chair*

- \* Supporting institutions

- \* **LIPN, Univ. P13** (website, administratif staff)
- \* **CNRS** (registration site)
- \* **Parsifal team, INRIA-LIX**
- \* **DIM RFSI** (Réseau Francilien en Sciences Informatiques)

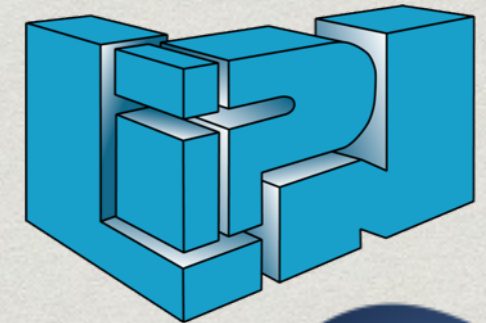



# UNIVERSITÉ PARIS 13

- \* One of the thirteen universities created after old Sorbonne reorganisation in 1968.
  - \* 5 campus
  - \* 23 000 students
  - \* 5 faculties, 3 IUT, 1 engineering schools
  - \* degrees and continuing education
- \* Multi-disciplinary

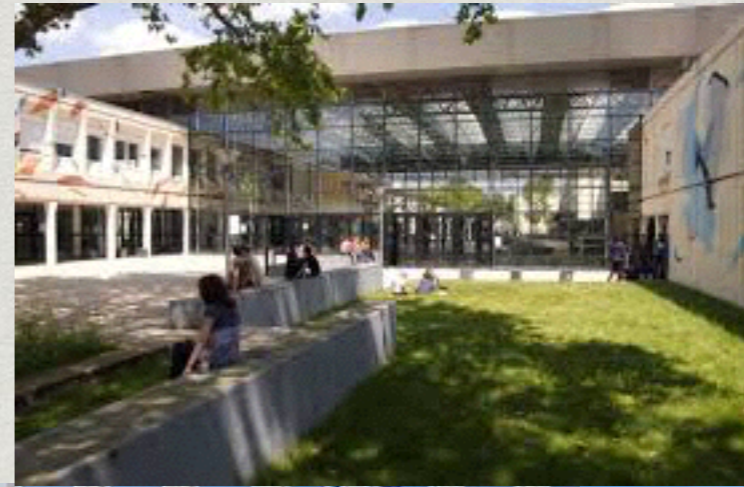

**A major center of teaching and research  
in the north of Paris**



# Institut Galilée

- \* **Licence, Master, Engineering school, Doctorate**
- \* **Faculty of Sciences**
  - \* Mathematics
  - \* Computer Science
  - \* Physics
  - \* Chemistry
- \* **7 Research Laboratories**





# LoVe LIPN

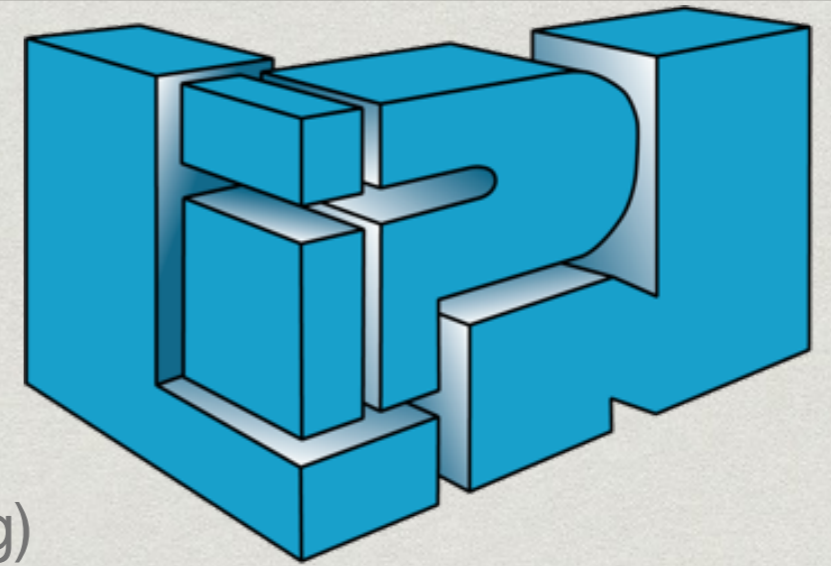

- \* **LoVe (Logic and Verification)** team  
formerly LCR (Logic, Computation and Reasoning)
  - \* 24 permanent researchers (*enseignants-chercheurs* or *chercheurs*)
  - \* 15 PhD students
- \* Two main research areas:
  - \* specification and verification
  - \* logics, theory of computation, and programming languages
- \* **LIPN (*Laboratoire d'Informatique Paris NORD*)**  
Created in 1987: it is 31 years old!
  - \* 4 research teams:
    - \* CALIN (combinatorics)
    - \* AOC (operational research and distributed computation)
    - \* RCLN (computational linguistics)
    - \* A3: machine learning





# INRIA Saclay



- \* **INRIA** (Institut National de Recherche en Informatique et en Automatique)  
French National Institute for computer science and applied mathematics
  - \* 8 research centres
  - \* two in the Paris region: **Paris** and **Saclay**
- \* **INRIA Saclay** is co-located with
  - \* **LIX** (Laboratoire d'Informatique de l'École Polytechnique)
  - \* **LRI** (Laboratoire de Recherche en Informatique) CNRS et Univ. Paris Sud
  - \* **LSV** (Laboratoire Spécification et Vérification} ENS Paris Saclay (by 2020)
- \* **Université Paris Saclay**  
a multi-university consortium formed of  
École Polytechnique, Université Paris Sud, and ENS Paris Saclay



# Parsifal team



- \* Main research topics:
  - \* foundational aspects of proof theory
  - \* design and implementation of systems
    - \* supporting: logic programming, model checking, automated reasoning
  - \* implemented systems used to study computational logic issues
    - \* program correctness, security,
    - \* concurrency
    - \* operational semantic specifications and their formalised meta-theory
    - \* structural proof theory





# The venue



- \* **MSH Paris Nord**

Maison des Sciences de l'Homme Paris Nord

- \* It hosts, supports, promotes, and disseminates research in the social and human sciences.

- \* The first major facility on the new **Condorcet Campus**.

- \* Paris 8 and 13 Universities and CNRS

- \* A new building completed in spring 2015

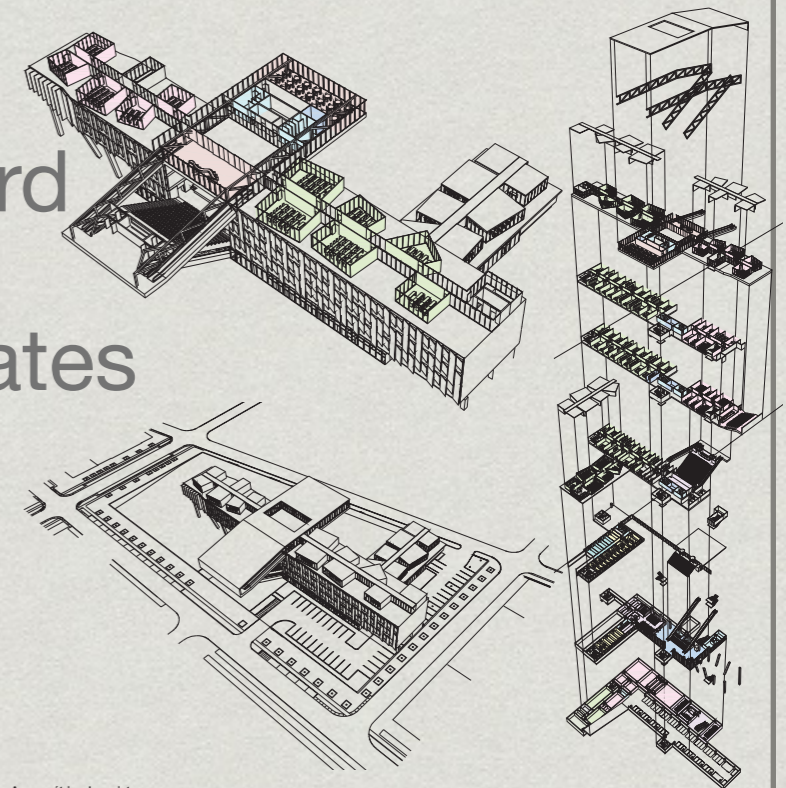



# The area



- ✦ **La Plaine Saint Denis:** strong urban renovation and development.
- ✦ **Campus Condorcet:** a new-multi university campus for humanities





# Facilities

- \* **1 Auditorium (300 p.)**
- \* **1 Theatre (140 p.)**
- \* **Conference rooms**
- \* **Meeting rooms**
- \* **Possibility to video record/stream main events**

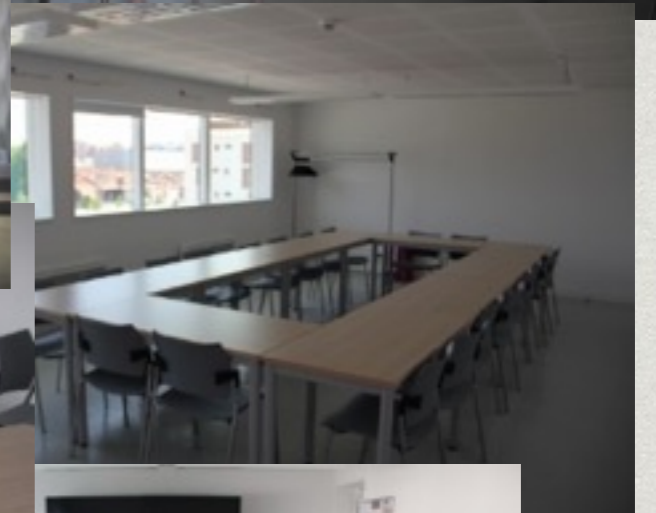



# Transports to/from Paris

- \* Two main **international airports**  
(*Charles de Gaulle et Orly, 40-50 min. from center Paris*)
- \* One **low cost flights** airport  
(*Beauvais, 2 h. from center Paris*)
- \* **Fast train connections** to  
central Europe and UK  
(*Amsterdam, Brussels, Germany, London, etc.*)





# Public transports in Paris

- \* 14 **Paris Metro** lines
- \* 5 **RER** lines (Ile-de France)
- \* 9 **tramway** lines
- \* Extensive **bus** network
- \* 1800 **bike sharing** stations

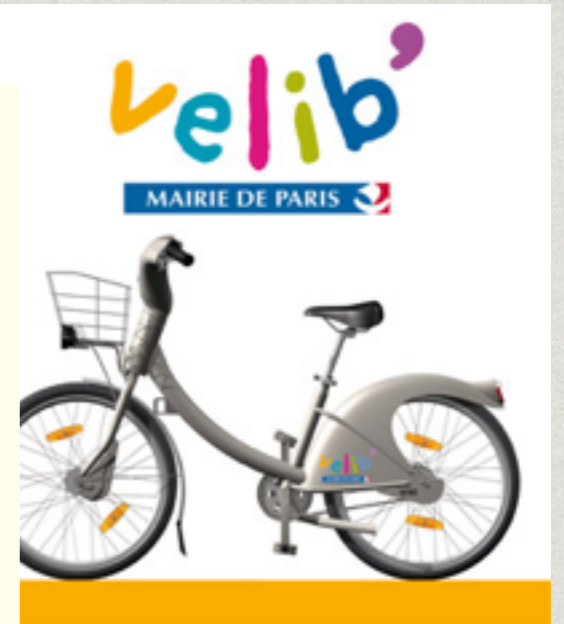



# Public transports to/from MSH

- \* Paris **Metro 12** station  
Front Populaire  
(240 m., 3 min.)
  - \* direct connections to:  
Montmartre (10-15 min.)  
Gare Saint Lazare (20 min.)  
Place de la Concorde (23 min.)
- \* **Bus stops: 139, 239**
  - \* connecting to:  
Porte de la Villette,  
Stade de France,  
St. Denis
- \* **20-25 min. to Châtelet-Les Halles**

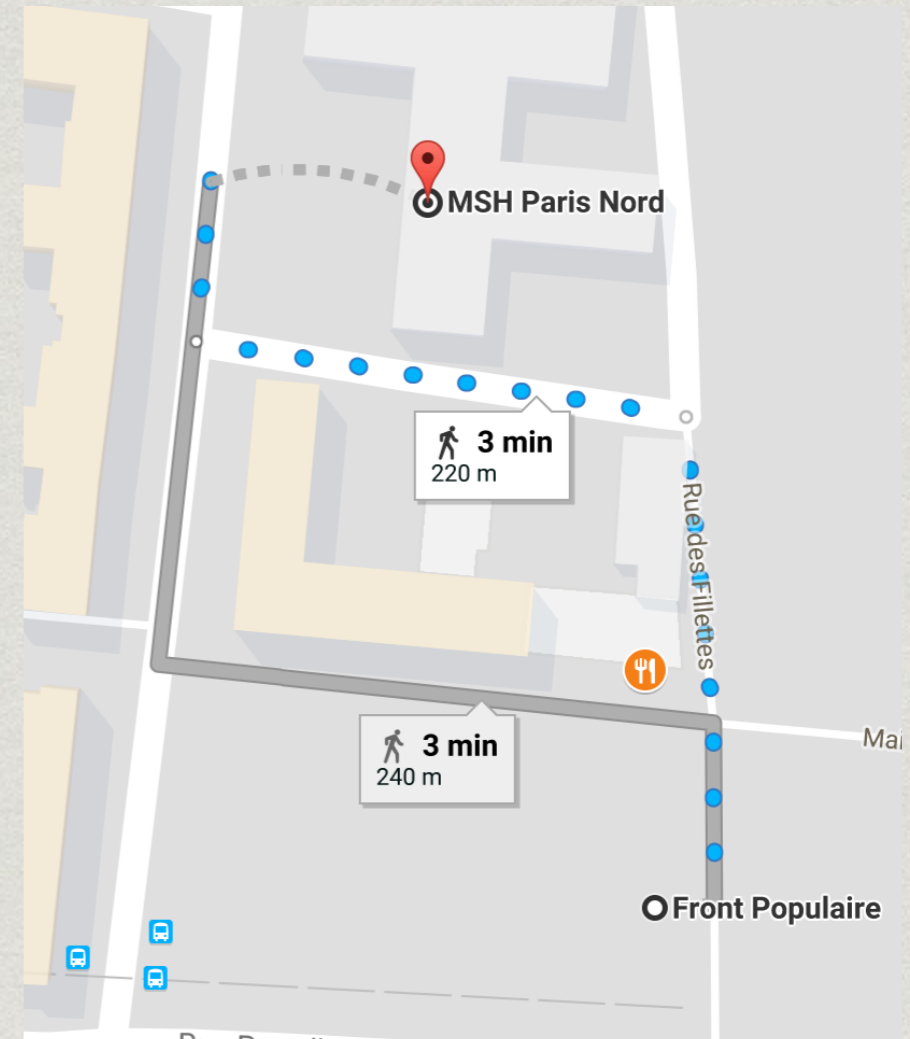



# Accommodation

- \* **Hotels**
- \* **B&B**
- \* **Airbnb**
- \* **Student accommodation**  
(campus Villetaneuse, 35 min.)
- \* Any price and any quality!





# Accommodation

Hotel and B&B  
(within ~3 km)





# Events

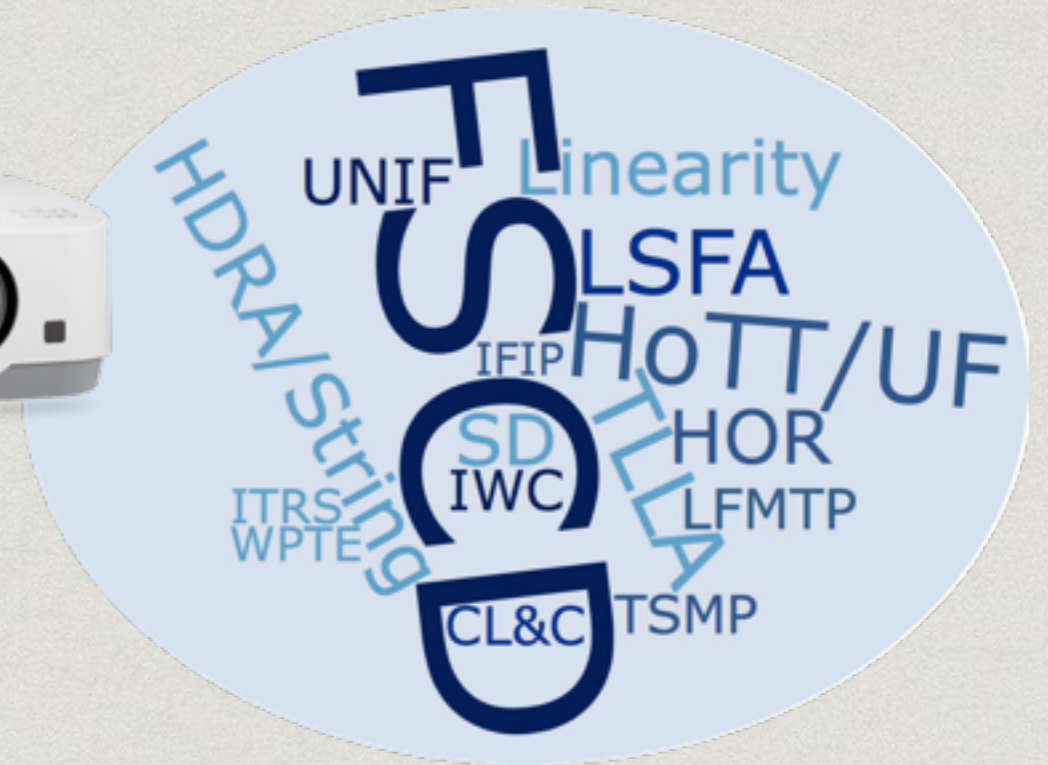

## \* Conferences

- \* FSCD-IJCAR: 4 days
- \* Workshops: 3 days

## \* Social/business events

- \* Reception drink
- \* Social event/banquet
- \* Business meeting cocktail
- \* Committees meetings

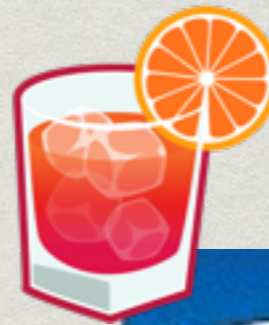



# Registration fees



- \* Keep registration fees as low as possible
  - \* **FSCD: 320-360 €** (less than previous editions)
  - \* **Workshops: 50 € per day** (as first two previous editions)

- \* Include:

- \* **Lunches and coffee breaks**
- \* **Social event/banquet**
- \* **Reception drink**
- \* Business meeting **cocktail**
- \* Participant pack







# Budget: revenue

<b>FSCD</b>	<b>80/90 p.</b>		<b>105/120 p.</b>		<b>145/150 p.</b>	
<b>Registrations (320 €/p.)</b>	€	25 600	€	33 600	€	46 400
<b>Subventions</b>	€	12 000	€	12 000	€	12 000
<b>Budget</b>	€	<b>37 600</b>	€	<b>45 600</b>	€	<b>58 400</b>

<b>Workshops</b>	<b>50 p./day</b>		<b>90 p./day</b>	
<b>Registrations (50 €/p./day)</b>	€	7 500	€	13 500
<b>Subventions</b>	€	3 000	€	3 000
<b>Budget</b>	€	<b>10 500</b>	€	<b>16 500</b>

- \* Estimated with **320 €/p. FSCD** reg. fee and **50 €/p./day WS** reg. fee
- \* Sponsors: **CNRS (5000 €), Paris 13 (3000 €), others (7000 €).**



# Budget: expenses



<b>Expenses</b>	<b>Pessimistic</b>	<b>Optimistic</b>	<b>Very Optimistic</b>
<b>Budget</b>	€ 48 100	€ 60 600	€ 74 900
<b>FSCD Invited speakers</b>	€ 6 200	€ 6 200	€ 6 200
<b>Lunches/coffee breaks</b>	€ 16 000	€ 24 000	€ 27 500
<b>Social events</b>	€ 8 000	€ 11 300	€ 14 500
<b>Publicity and proceedings</b>	€ 4 000	€ 4 000	€ 4 000
<b>Other</b>	€ 4 000	€ 4 500	€ 4 800
<b>Awards/Grants/WS subventions</b>	€ 9 900	€ 10 600	€ 17 900

- \* More participants (and additional sponsors) increase budget for
  - \* awards
  - \* student grants
  - \* subventions for workshop (invited speakers, ...)



# FSCD Paris 2020

- \* We are open to propositions for additional related events
  - \* posters
  - \* student sessions
  - \* demo sessions



Let us meet in Paris in July 2020!

